

Smith Residence

DESIGN CRITERIA

CODES: IRC 2018, IECC 2018,
 IMC 2018, ISPC 2015, NEC 2017,
 CLIMATE ZONE: 6
 FROST DEPTH: 24"
 SEISMIC ZONE: D
 WIND SPEED: 115 MPH
 SOIL BEARING: 1500 PSF
 ROOF LOADS: 17 PSF (DEAD)
 150 PSF (SNOW)
 167 PSF
 FLOOR LOADS: 17 PSF (DEAD)
 40 PSF (LIVE)
 57 PSF

SHEET INDEX

1	SITE PLAN
2	FLOOR PLAN
3	ROOF PLAN
4	ELEVATIONS
5	ELEVATIONS
6	SECTIONS
7	POWER AND LIGHTING PLAN
S1	GENERAL STRUCTURAL NOTES
S1.1	STANDARD DETAILS AND SCHEDULES
S1.2	STANDARD DETAILS AND SCHEDULES
S2	FOUNDATION PLAN
S3	FLOOR FRAMING PLAN
S4	ROOF FRAMING PLAN
S5	SHEAR WALL PLAN
SD-1	STRUCTURAL DETAILS
SD-2	STRUCTURAL DETAILS

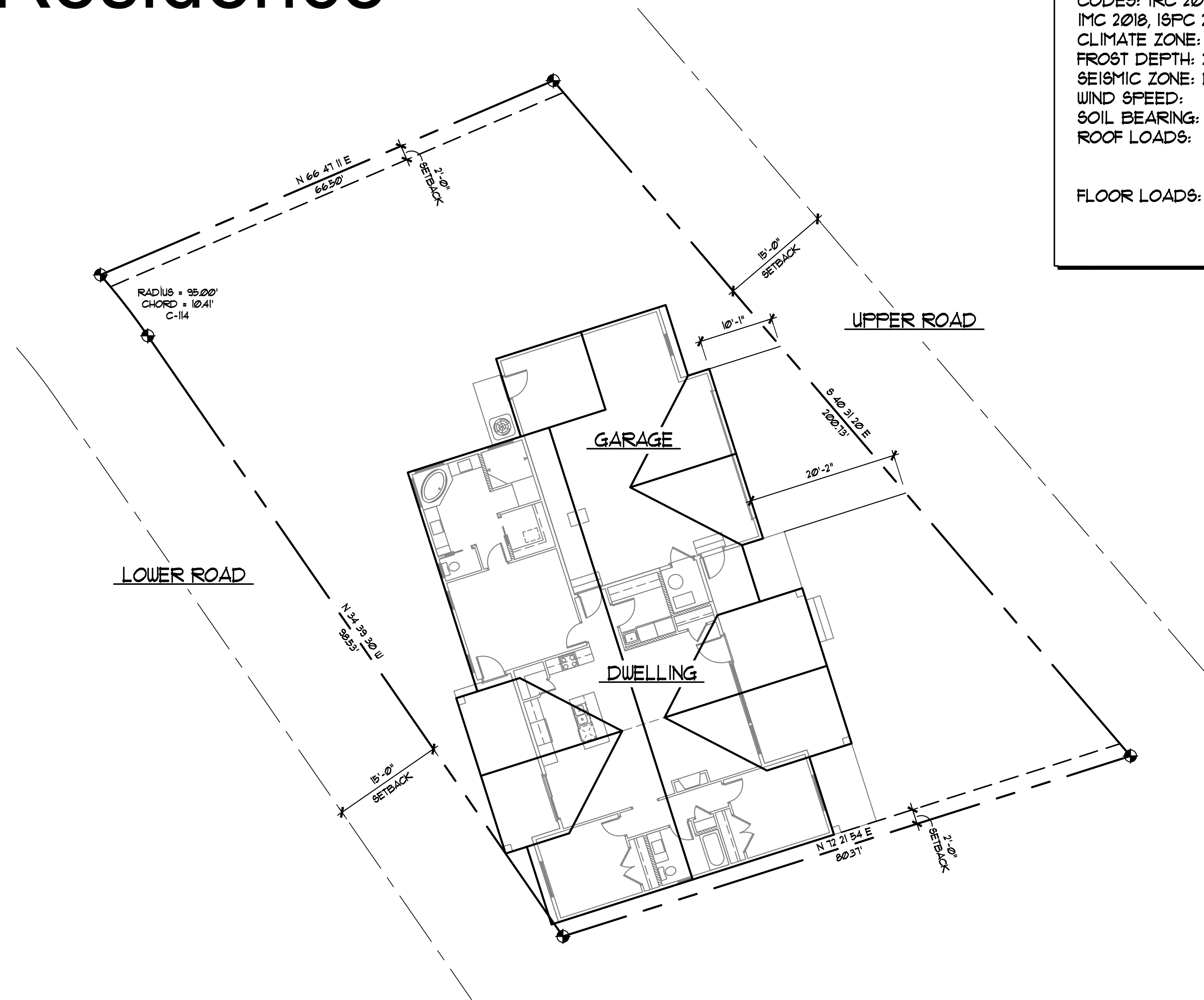

This project to comply with the Prescriptive Component Approach as required by the building department

PRESCRIPTIVE ENERGY COMPLIANCE: 2018 INTERNATIONAL ENERGY CONSERVATION CODE (IECC)

THE PROPOSED BUILDING HAS BEEN DESIGNED TO MEET OR EXCEED THE REQUIREMENTS OF THE INTERNATIONAL ENERGY CONSERVATION CODE

INSULATION AND FENESTRATION BY COMPONENT

CLIMATE ZONE	FENESTRATION U-FACTOR	SKYLIGHT U-FACTOR	GLAZED FENESTRATION SHGC	CEILING R-VALUE	WOOD FRAME WALL R-VALUE	MASS WALL R-VALUE	FLOOR R-VALUE	BASEMENT WALL R-VALUE	SLAB R-VALUE AND DEPTH	CRAWL SPACE WALL R-VALUE
6	.32	.55	NR	49	20	13/17	30	15/19	10, 2ft	15/19

SITE PLAN

1" = 10'

LOT 44 BLOCK 13 TERRACE LAKES RECREATION RANCH - UNIT No.8 BOISE COUNTY, IDAHO

SMITH RESIDENCE

Mike Carroll Design

208-841-1557
mike@mcdesign.house

© MCD 2022

ALL DRAWINGS SHALL BE REVIEWED AND VERIFIED BY CONTRACTOR PRIOR TO CONSTRUCTION. MIKE CARROLL SHALL BE NOTIFIED OF ANY ERROR IN PLANS PRIOR TO CONSTRUCTION.

PROJECT No.

SITE PLAN

DATE OF LAST REVISION

3 OCT. 2022

DESIGNER

M.C.

SHEET

1